

MF Seals
POUZDAN PARTNER U TEHNICI ZAPTIVANJA

KATALOG
ZAPTIVAČA



www.mfseals.rs

MI UVEK IMAMO PRAVO REŠENJE ZA VAS!

> PROIZVODNI PROGRAM

Zaptivači izrađeni seal master tehnologijom

Seal-Master tehnologija predstavlja moderan koncept proizvodnje zaptivača, zaptivnih setova i drugih zaptivnih elemenata za hidrauliku i pneumatiku.

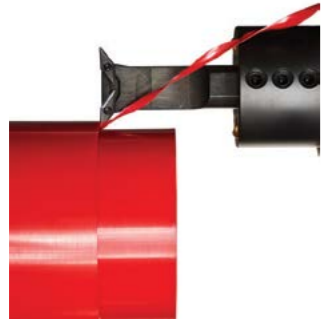

Ovom tehnologijom možemo veoma precizno da proizvedemo u najkraćem roku, praktično odmah, sve zaptivače u rasponu prečnika od 5mm do 600mm. Veće dimenzije, do 2000mm, izrađujemo sa rokom isporuke do dve nedelje.

Ovom tehnologijom eliminiše se prethodna izrada alata za zaptivače, tako da se zaptivači mogu proizvesti u bilo kojoj standardnoj i nestandardnoj dimenziji.



> VRSTE MATERIJALA OD KOJIH SE IZRAĐUJU ZAPTIVAČI

HPU - TERMOPLASTIČNI ELASTOMER - POLIURETAN - CRVENI

Zaptivni materijal koji je izuzetno otporan na habanje i ekstruziju. Lako se ugrađuje zbog svoje velike elastičnosti. Otporan je na HFA, HFB ulja, vodu, morsku vodu, dozvoljena primena u prehrambenoj industriji. Primenljiv je u rudarstvu. VEOMA JE OTPORAN NA HIDROLIZU. Tvrdća 85 Shore A. Temperaturno područje primene -40 do +100 stepeni celzijusa. Primena: do 400 Bara.

H-NBR - HIDRARANA AKRILNITRIL BUTADIJEN GUMA

Elastomer otporan na habanje, otporan na medije kao što su ugljovodoni (Propan, Butan), mineralna ulja i masti, biljne i životinjske masti, razblažene kiseline, baze i soli i pri povišenim temperaturama. Tvrdća 85 Shore A. Temperaturno područje primene -40 do +150 stepeni celzijusa. Primena: do 250 Bara.

POM - POLIACETAL - KOPOLIMER

POM se koristi za izradu potpornih prstenova, vodećih elemenata, čaura, a zamenjuje i metalne delove zaptivača (kod brisača, za aksijalno otvorena kućišta, radialnih osovinjskih zaptivača...). Ima odlična mehanička svojstva, hemijski je veoma otporan. Temperaturno područje primene: -40 do +100 stepeni celzijusa.

MVQ - METIL-VINIL-SILIKON-KAUČUK

Otporan je na atmosferske uticaje, ozon, zagrejani vazduh. Ima dobra elektroizolaciona svojstva. Mehanička svojstva niža od ostalih materijala. Tvrdća 85 Shore A. Temperaturno područje primene: -60 do +220 stepeni celzijusa. Primena: statička aplikacija.

PTFE I - POLITETRAFLUORETILEN PLASTOMER - STAKLO

Materijal koji se koristi u modernim zaptivnim sistemima. Ima odlična mehanička svojstva, hemijski je otporan i u slučajevima kada je medijem emulzija.

Temperaturno područje primene: -200 do +280 stepeni celzijusa.

NBR - AKRILNITRIL BUTADIJEN GUMA

Zaptivni materijal otporan na habanje. Lako se ugrađuje zbog svoje velike elastičnosti. Otporan na mineralna ulja, masti, HFA, HFB I HFC hidraulična ulja. Nije otporan na kočiona ulja na bazi glikola, HFD ulja, arome (npr. Benzol), Estere, Ketone i Amine, kao i na koncentrovane kiseline i baze. Tvrdća 85 Shore A. Temperaturno područje primene: -40 do +100 stepeni celzijusa. Primena: do 250 Bara.

FPM - FLUOR - KAUČUK (FPM ILI FKM)

Materijal od kojeg se izrađuju hidraulični zaptivači i drugi zaptivni elementi za primenu na povišenim temperaturama. IMA ZNAČAJNU OTPORNOST NA HEMIJSKI AGRESIVNE MEDIJE. Tvrdća 85 Shore A. Temperaturno područje primene -20 do +200 stepeni celzijusa. Primena: standardna hidraulika do 250 Bara i pri povišenim temperaturama.

EPDM - ETILEN-PROPILEN-DIEN-KAUČUK

Ovaj elastomer je otporan na starenje, ozon, atmosferske uticaje. Takođe je otporan na kočiona ulja, vruću vodu, paru, polarne rastvarače i sredstva za pranje na baznoj osnovi. Tvrdća 85 Shore A. Temperaturno područje primene: -50 do +150 stepeni celzijusa. Primena: kao zaptivač kočionih sistema, u hemijskoj industriji i energetici.

PTFE - ČIST POLITETRAFLUORETILEN PLASTOMER

Ovaj materijal odlikuje odlična hemijska otpornost. Otporan je na skoro sve medije. Najčešća primena je u farmaceutskoj, prehrambenoj i hemijskoj industriji.

Temperaturno područje primene: -200 do +280 stepeni celzijusa.

PTFE II - POLITETRAFLUORETILEN PLASTOMER - BRONZA

Tipičan materijal za proizvodnju modernih zaptivnih setova za zaptivanje klipa, klipnjače, kao i za vođice i brisače. Otporan je na habanje, ima odlična klizna svojstva, veoma je hemijski otporan. Nije pogodan za primenu u rudarstvu (bronzna nije otporna na emulziju). Temperaturno područje primene: -200 do +280 stepeni celzijusa.

MATERIJAL			H-PU	NBR	H-NBR	EPDM	VMQ	FPM	PTFE	PTFE I	PTFE II	POM
BOJA:			Crvena	Crna	Zelena	crna	Plava	Braon	Bela	Staklo	Bronza	Bela
OSOBINE:												
Tvrdoća	DIN 53505	Shore A	94	85	85	85	85	85	55D	63D	69D	85D
Zatezna čvrstoća	DIN 53504	N/mm ²	60	17	19.5	14	7.5	14	27	15	14	70
Čvrstoća na kidanje	DIN 53504	%	430	150	245	130	150	200	350	280	170	40
Modul elastičnosti 100%	DIN 53504	N/mm ²	16	11	9.7	9.2		10				
Modul elastičnosti 300%	DIN 53504	N/mm ²	35									
Elastičnost	DIN 535012	%	35	20	30	34	35	7				
Jačina pri kidanju	DIN53507	N/mm	150	9	6	9	12	6				
Specifična težina	DIN 53479	g/cm ³	1.2	1.32	1.32	1.23	1.6	2.51	2.16	2.3	3.2	1.41
Abrazija	DIN 53516	mm ³	18	130	110	108		200				
Trajna deformacija 70° / 70 ^h	DIN 53517	%	28			24						
Trajna deformacija 100° / 22 ^h	DIN 53517	%		9	21.1	18		5				
Trajna deformacija 150° / 22 ^h	DIN 53517	%			27.7	20		6				
Trajna deformacija 175° / 22 ^h	DIN53517	%					34	7.7				
Minimalna temperatura		°C	-35	-35	-20	-40	-60	-20	-200	-200	-200	-45
Maksimalna temperatura		°C	110	120	150	120	220	220	260	260	260	100
Maks.temperatura voda/para		°C	80		130	150	120	150				
Maks. temperatura vruć vazduh		°C			180 short	180 short	300 short	300 short				
E-modul	DIN 53457	N/mm ²							540	1320	1375	3000

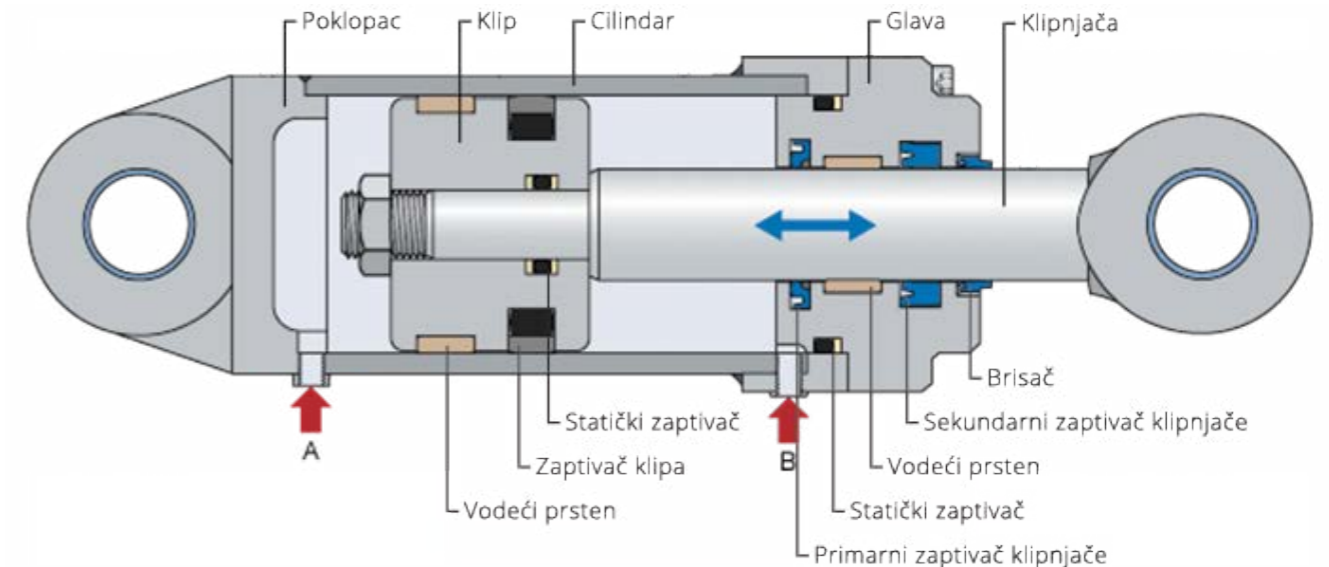

PROFILI KOJE IZRAĐUJEMO

> PROFILI BRISAČA (DA)

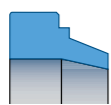

DA 101

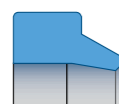

DA 102

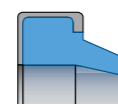

DA 103

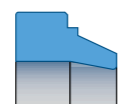

DA 104

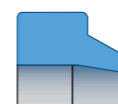

DA 105

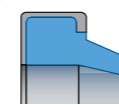

DA 106

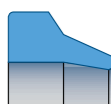

DA 107

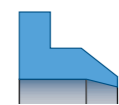

DA 108



DA 109



DA 211



DA 212



DA 113



DA 213



DA 114

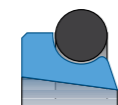

DA 115

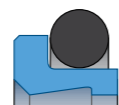

DA 116

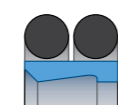

DA 117



DA 118

> PROFILI ZAPTIVAČA KLIPNJAČE (DS)



DS 101



DS 102



DS 102R

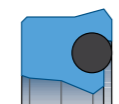

DS 103



DS 104

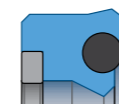

DS 104R



DS 105



DS 205



DS 106

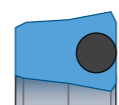

DS 107

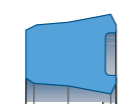

DS 108

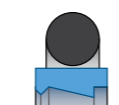

DS 109



DS 110-112

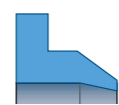

DS 116

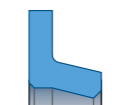

DS 216

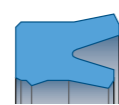

DS 117



DS 117R



DS 119



DS 120

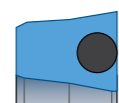

DS 121

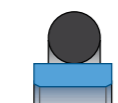

DS 124

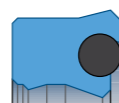

DS 125



DS 126-128

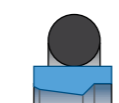

DS 129



DS 130

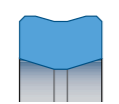

DS 131



DS 138

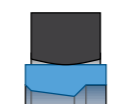

DS 238



DS 139



DS 141

> PROFILI ZAPTIVAČA KLIPA (DK)



DK 101



DK 102



DK 102R

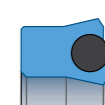

DK 103

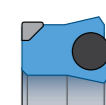

DK 104



DK 104R



DK 105



DK 205



DK 106

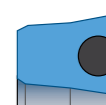

DK 107

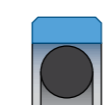

DK 108

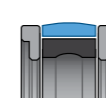

DK 109

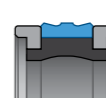

DK 109D

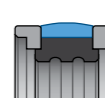

DK 109H

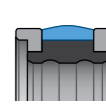

DK 109N



DK 110-112



DK 116

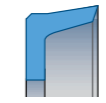

DK 216

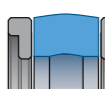

DK 117

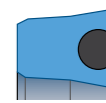

DK 118



DK 119



DK 120



DK 122



DK 222



DK 123



DK 123D



DK 123H



DK 123N



DK 124



DK 125



DK 126



DK 127



DK 138



DK 238



DK 139



DK 140



DK 141



DK 142

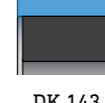

DK 143

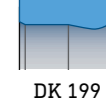

DK 199

> PROFILI ROTACIONIH ZAPTIVAČA (DR)

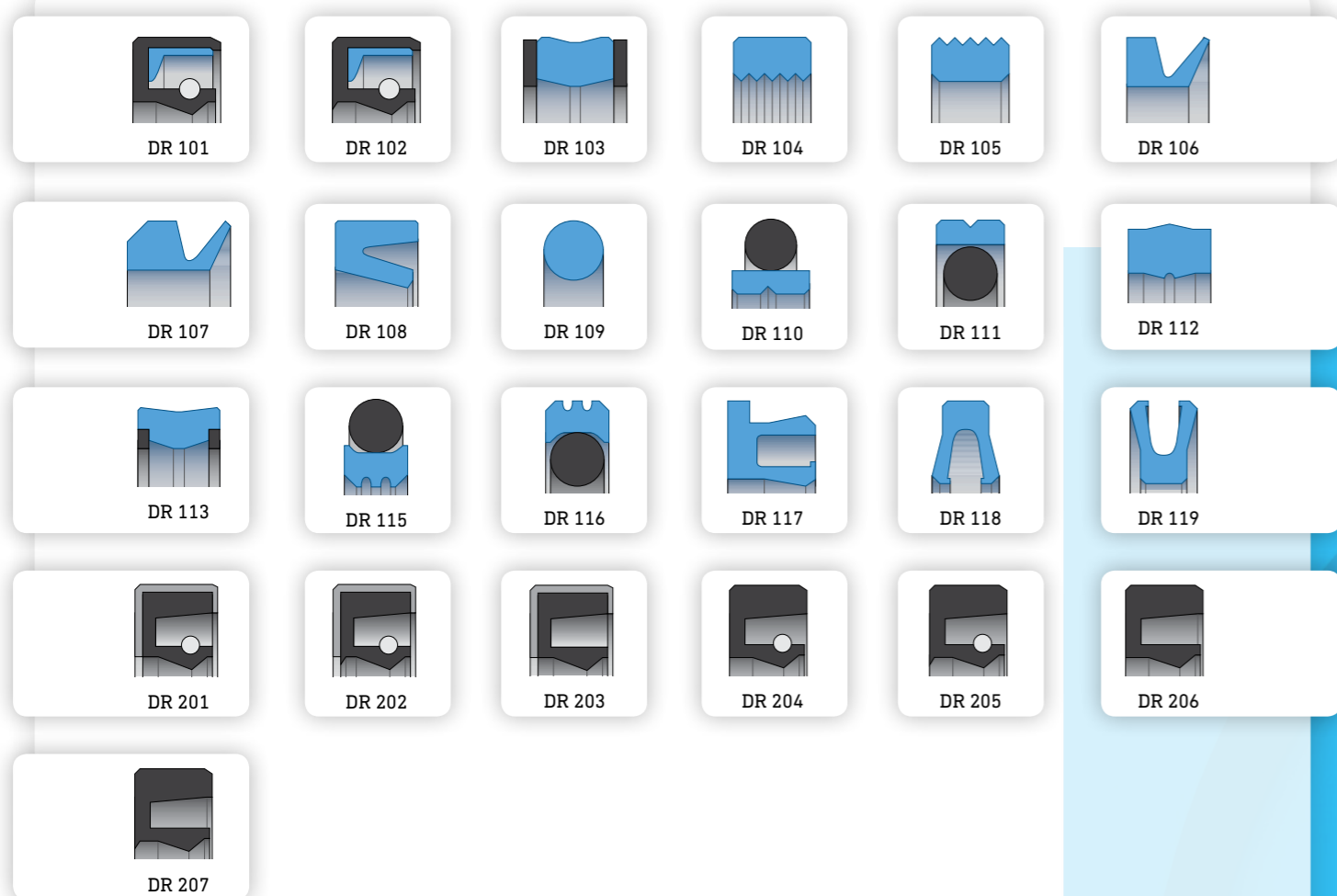

> PROFILI VODEĆIH PRSTENOVA (DF)

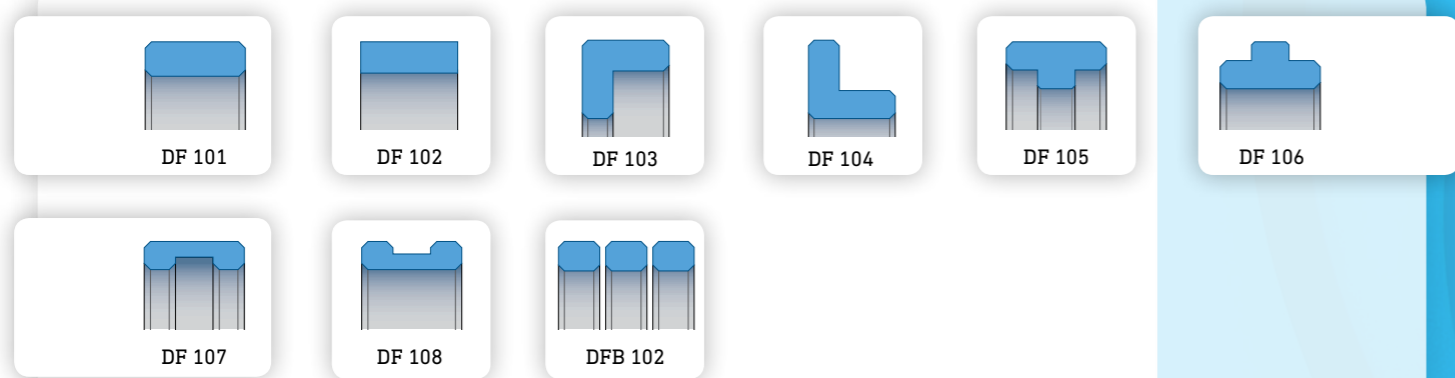

> PROFILI POTPORNIH PRSTENOVA (DST)

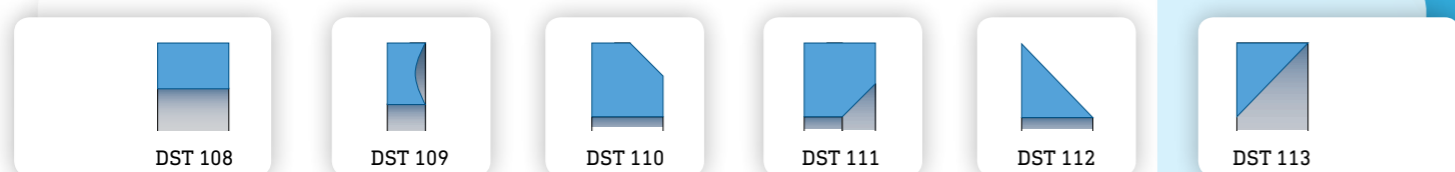

> PROFILI ZAPTIVAČA (DFL)



BRISAČI

Preporuka za kvalitet obrade površine

MIN. I MAKS. VREDNOSTI	R_{Max}	R_a
KLIZNA POVRŠINA	$\leq 2.5\mu m$	0.05-0.3 μm
DNO KANALA	$\leq 6.3\mu m$	$\leq 1.6\mu m$
BOČNE STRANE KANALA	$\leq 15\mu m$	$\leq 3\mu m$

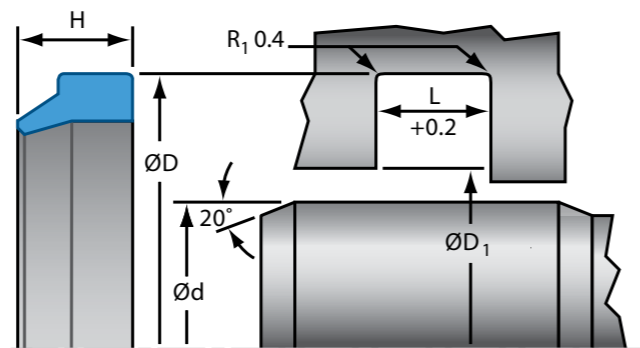

Standardne dimenzije

$\varnothing d$	$\varnothing D$	D_1	L	H
20-80	$\varnothing d+8.6$	$\varnothing d+3.0$	5.3	7.0
81-150	$\varnothing d+12.2$	$\varnothing d+6.0$	7.2	12.0
151-500	$\varnothing d+20.0$	$\varnothing d+10.0$	10.2	18.0
501-1000	$\varnothing d+25.0$	$\varnothing d+12.6$	12.7	20.0

Profili brisača

PROFIL	TIP	STANDARDNI MATERIJALI	TEMPERATURNI PODRUČJE	AKSIJALNA BRZINA
	DA102	94AU925 (P100) Red HPU (P500) NBR (N100)	-30 to +110°C (-22°F to +230°F) -20 to +110°C (-7°F to +230°F) -30 to +110°C (-22°F to +230°F)	2.0 m/s
	DA103	94AU925 (P100) / POM Red HPU (P500) / POM NBR (N100) / POM	-30 to +110°C (-22°F to +230°F) -20 to +110°C (-7°F to +230°F) -30 to +110°C (-22°F to +230°F)	2.0 m/s
	DA105PN	94AU925 (P100) / POM Red HPU (P500) / POM NBR (N100) / POM	-30 to +110°C (-22°F to +230°F) -20 to +110°C (-7°F to +230°F) -30 to +110°C (-22°F to +230°F)	2.0 m/s
	DA106PN	94AU925 (P100) / POM Red HPU (P500) / POM NBR (N100) / POM	-30 to +110°C (-22°F to +230°F) -20 to +110°C (-7°F to +230°F) -30 to +110°C (-22°F to +230°F)	2.0 m/s
	DA101	94AU925 (P100) Red HPU (P500) NBR (N100)	-30 to +110°C (-22°F to +230°F) -20 to +110°C (-7°F to +230°F) -30 to +110°C (-22°F to +230°F)	2.0 m/s

BRISAČI

PROFIL	TIP	STANDARDNI MATERIJALI	TEMPERATURNI PODRUČJE	AKSIJALNA BRZINA
	DA104PN	94AU925 (P100) Red HPU (P500) NBR (N100)	-30 to +110°C (-22°F to +230°F) -20 to +110°C (-7°F to +230°F) -30 to +110°C (-22°F to +230°F)	2.0 m/s
	DA107	94AU925 (P100) Red HPU (P500) NBR (N100)	-30 to +110°C (-22°F to +230°F) -20 to +110°C (-7°F to +230°F) -30 to +110°C (-22°F to +230°F)	2.0 m/s
	DA108	94AU925 (P100) Red HPU (P500) NBR (N100)	-30 to +110°C (-22°F to +230°F) -20 to +110°C (-7°F to +230°F) -30 to +110°C (-22°F to +230°F)	2.0 m/s
	DA109	94AU925 (P100) Red HPU (P500) NBR (N100)	-30 to +110°C (-22°F to +230°F) -20 to +110°C (-7°F to +230°F) -30 to +110°C (-22°F to +230°F)	2.0 m/s
	DA111	94AU925 (P100) Red HPU (P500) NBR (N100)	-30 to +110°C (-22°F to +230°F) -20 to +110°C (-7°F to +230°F) -30 to +110°C (-22°F to +230°F)	2.0 m/s
	DA112	94AU925 (P100) Red HPU (P500) NBR (N100)	-30 to +110°C (-22°F to +230°F) -20 to +110°C (-7°F to +230°F) -30 to +110°C (-22°F to +230°F)	2.0 m/s
	DA113	94AU925 (P100) Red HPU (P500) NBR (N100)	-30 to +110°C (-22°F to +230°F) -20 to +110°C (-7°F to +230°F) -30 to +110°C (-22°F to +230°F)	2.0 m/s
	DA115	PTFE Bronze PTFE Glass MoS2 with NBR or FPM energizer	-30 to +150°C (-22°F to +300°F)	2.0 m/s
	DA116	PTFE Bronze PTFE Glass MoS2 with NBR or FPM energizer	-30 to +150°C (-22°F to +300°F)	2.0 m/s
	DA117	PTFE Bronze PTFE Glass MoS2 with NBR or FPM energizer	-30 to +150°C (-22°F to +300°F)	2.0 m/s

› ZAPTIVAČI KLIPNJAČE

› Standardne dimenzije ‹

Ød	ØD	L	C/S
5-24.9	ØD+8.0	6.3	4.0
25-49.9	ØD+10.0	8.0	5.0
50-149.9	ØD+15.0	10.0	7.5
150-299.9	ØD+20.0	14.0	10.0
300-499.9	ØD+25.0	17.0	12.5
500-699.9	ØD+30.0	25.0	15.0
≥700	ØD+40.0	32.0	20.0

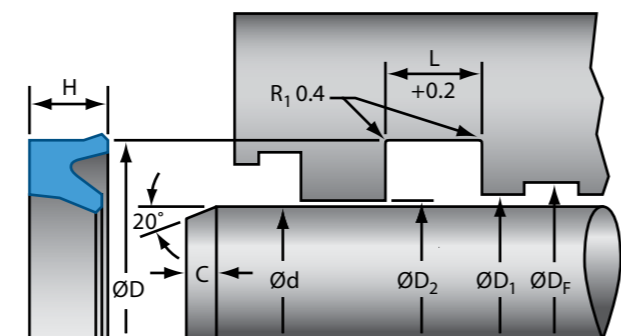

MIN. I MAKS. VREDNOSTI	R _{Max}	R _a
KLIZNA POVRŠINA	≤2.5µm	0.05-0.3µm
DNO KANALA	≤6.3µm	≤1.6µm
BOČNE STRANE KANALA	≤15µm	≤3µm

› Profili zaptivača klipnjače ‹

PROFIL	TIP	STANDARDNI MATERIJALI	TEMPERATURNI PODRUČJE	AKSIJALNA BRZINA
	DS101	94AU925 (P100) Red HPU (P500) NBR (N100)	-30 to +110°C (-22°F to +230°F) -20 to +110°C (-7°F to +230°F) -30 to +110°C (-22°F to +230°F)	0.5 m/s
	DS102	94AU925 (P100) / POM Red HPU (P500) / POM NBR (N100) / POM	-30 to +110°C (-22°F to +230°F) -20 to +110°C (-7°F to +230°F) -30 to +110°C (-22°F to +230°F)	0.5 m/s
	DS103	94AU925 / NBR Red HPU (N100) / NBR	-30 to +110°C (-22°F to +230°F) -20 to +110°C (-7°F to +230°F)	0.5 m/s
	DS104	94AU925 / NBR / POM Red HPU / NBR / POM	-30 to +110°C (-22°F to +230°F) -20 to +110°C (-7°F to +230°F)	0.5 m/s

› ZAPTIVAČI KLIPNJAČE

PROFIL	TIP	STANDARDNI MATERIJALI	TEMPERATURNI PODRUČJE	AKSIJALNA BRZINA
	DS105PN	94AU925 (P100) Red HPU (P500) NBR (N100)	-30 to +110°C (-22°F to +230°F) -20 to +110°C (-7°F to +230°F) -30 to +110°C (-22°F to +230°F)	0.5 m/s
	DS106	94AU925 (P100) Red HPU (P500) NBR (N100)	-30 to +110°C (-22°F to +230°F) -20 to +110°C (-7°F to +230°F) -30 to +110°C (-22°F to +230°F)	0.5 m/s
	DS107	94AU925 / NBR Red HPU / NBR	-30 to +110°C (-22°F to +230°F) -20 to +110°C (-7°F to +230°F)	0.5 m/s
	DS108	94AU925 (P100) Red HPU (P500) NBR (N100)	-30 to +110°C (-22°F to +230°F) -20 to +110°C (-7°F to +230°F) -30 to +110°C (-22°F to +230°F)	0.5 m/s
	DS117	94AU925 (P100) Red HPU (P500) NBR (N100)	-30 to +110°C (-22°F to +230°F) -20 to +110°C (-7°F to +230°F) -30 to +110°C (-22°F to +230°F)	0.5 m/s
	DS121	94AU925 (P100) / NBR Red HPU (P500) / NBR	-30 to +110°C (-22°F to +230°F) -20 to +110°C (-7°F to +230°F)	0.5 m/s
	DS125	94AU925 (P100) / NBR Red HPU (P500) / NBR	-30 to +110°C (-22°F to +230°F) -20 to +110°C (-7°F to +230°F)	0.5 m/s
	DS139	94AU925 (P100) Red HPU (P500) NBR (N100)	-30 to +110°C (-22°F to +230°F) -20 to +110°C (-7°F to +230°F) -30 to +110°C (-22°F to +230°F)	0.5 m/s
	DS1141	94AU925 (P100) / POM Red HPU (P500) / POM NBR (N100) / POM	-30 to +110°C (-22°F to +230°F) -20 to +110°C (-7°F to +230°F) -30 to +110°C (-22°F to +230°F)	0.5 m/s

> PTFE ZAPTIVAČI KLIPNJAČE

> Standardne dimenzije <

Ød	ØD	L	C/S
5-24.9	ØD+8.0	6.3	4.0
25-49.9	ØD+10.0	8.0	5.0
50-149.9	ØD+15.0	10.0	7.5
150-299.9	ØD+20.0	14.0	10.0
300-499.9	ØD+25.0	17.0	12.5
500-699.9	ØD+30.0	25.0	15.0
≥700	ØD+40.0	32.0	20.0

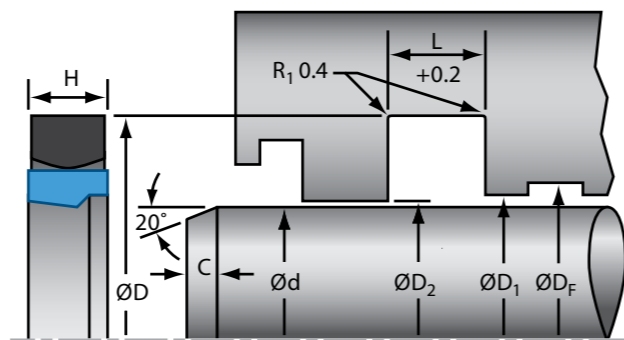

MIN. I MAKS. VREDNOSTI	R _{Max}	R _a	R _{pkx}	R _{pk}	R _k	R _{vk}	R _{vkx}
KLIZNA POVRŠINA	≤2.5µm	0.05 - 0.3µm	<0.5µm	<0.5µm	0.25 - 0.7µm	0.2 - 0.65µm	0.2 - 2.0µm
DNO KANALA	≤6.3µm	≤1.6µm					
BOČNE STRANE KANALA	≤15µm	≤3µm					

> Profili PTFE zaptivača klipnjače <

PROFIL	TIP	STANDARDNI MATERIJALI	TEMPERATURNI PODRUČJE	AKSIJALNA BRZINA
	DS124	PTFE Bronze / NBR PTFE Glass / NBR PTFE Bronze / FPM PTFE Glass / FPM	-30 to +120°C (-22°F to +248°F) -30 to +120°C (-22°F to +248°F) -10 to +200°C (-14°F to +390°F) -10 to +200°C (-14°F to +390°F)	5.0 m/s
	DS129	PTFE Bronze / NBR PTFE Glass / NBR PTFE Bronze / FPM PTFE Glass / FPM	-30 to +120°C (-22°F to +248°F) -30 to +120°C (-22°F to +248°F) -10 to +200°C (-14°F to +390°F) -10 to +200°C (-14°F to +390°F)	5.0 m/s
	DS138	PTFE Bronze / NBR PTFE Glass / NBR PTFE Bronze / FPM PTFE Glass / FPM	-30 to +120°C (-22°F to +248°F) -30 to +120°C (-22°F to +248°F) -10 to +200°C (-14°F to +390°F) -10 to +200°C (-14°F to +390°F)	5.0 m/s
	DS238	PTFE Bronze / NBR PTFE Glass / NBR PTFE Bronze / FPM PTFE Glass / FPM	-30 to +120°C (-22°F to +248°F) -30 to +120°C (-22°F to +248°F) -10 to +200°C (-14°F to +390°F) -10 to +200°C (-14°F to +390°F)	5.0 m/s
	DS142	PTFE Bronze / NBR PTFE Glass / NBR PTFE Bronze / FPM PTFE Glass / FPM	-30 to +120°C (-22°F to +248°F) -30 to +120°C (-22°F to +248°F) -10 to +200°C (-14°F to +390°F) -10 to +200°C (-14°F to +390°F)	5.0 m/s
	DS119	PTFE Bronze / SS PTFE Glass / SS	-200 to +260°C (-328°F to +500°F) -200 to +260°C (-328°F to +500°F)	5.0 m/s

> ZAPTIVAČI KLIPA

> Standardne dimenzije <

ØD	Ød	L	C/S
5-24.9	ØD+8.0	6.0	4.0
25-49.9	ØD+10.0	7.0	5.0
50-74.9	ØD+12.0	8.0	6.0
75-149.9	ØD+16.0	10.0	8.0
150-299.9	ØD+20.0	12.0	10.0
300-499.9	ØD+24.0	18.0	12.0
500-749.9	ØD+30.0	20.0	15.0
≥750	ØD+40.0	26.0	20.0

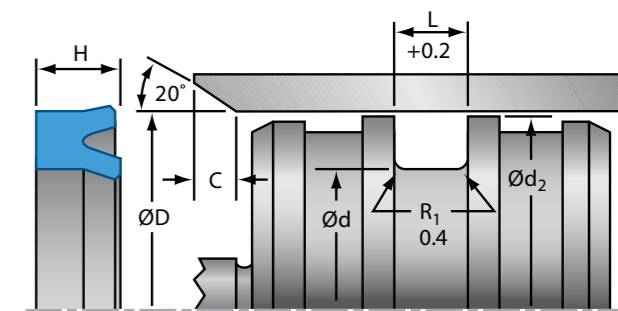





MIN. I MAKS. VREDNOSTI	R _{Max}	R _a
KLIZNA POVRŠINA	≤2.5µm	0.05-0.3µm
DNO KANALA	≤6.3µm	≤1.6µm
BOČNE STRANE KANALA	≤15µm	≤3µm

> Profili zaptivača klipa <

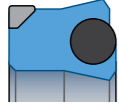
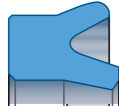
PROFIL	TIP	STANDARDNI MATERIJALI	TEMPERATURNI PODRUČJE	AKSIJALNA BRZINA
	DK101	94AU925 (P100) Red HPU (P500) NBR (N100)	-30 to +110°C (-22°F to +230°F) -20 to +110°C (-7°F to +230°F) -30 to +110°C (-22°F to +230°F)	0.5 m/s
	DK102	94AU925 / POM Red HPU / POM NBR / POM	-30 to +110°C (-22°F to +230°F) -20 to +110°C (-7°F to +230°F) -30 to +110°C (-22°F to +230°F)	0.5 m/s
	DK103	94AU925 (P100) / POM Red HPU (P500) / POM	-30 to +110°C (-22°F to +230°F) -20 to +110°C (-7°F to +230°F)	0.5 m/s

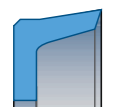
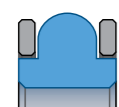
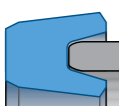
› ZAPTIVAČI KLIPA

PROFIL	TIP	STANDARDNI MATERIJALI	TEMPERATURNO PODRUČJE	AKSIJALNA BRZINA
	DK104	94AU925/NBR/POM Red HPU/NBR/POM	-30 to +110°C (-22°F to +230°F) -20 to +110°C (-7°F to +230°F)	0.5 m/s
	DK105PN	94AU925 (P100) Red HPU (P500) NBR (N100)	-30 to +110°C (-22°F to +230°F) -20 to +110°C (-7°F to +230°F) -30 to +110°C (-22°F to +230°F)	0.5 m/s
	DK141	94AU925 (P100) Red HPU (P500) NBR (N100)	-30 to +110°C (-22°F to +230°F) -20 to +110°C (-7°F to +230°F) -30 to +110°C (-22°F to +230°F)	0.5 m/s
	DK116	94AU925 (P100) Red HPU (P500) NBR (N100)	-30 to +110°C (-22°F to +230°F) -20 to +110°C (-7°F to +230°F) -30 to +110°C (-22°F to +230°F)	0.5 m/s
	DK216	94AU925 (P100) Red HPU (P500) NBR (N100)	-30 to +110°C (-22°F to +230°F) -20 to +110°C (-7°F to +230°F) -30 to +110°C (-22°F to +230°F)	0.5 m/s
	DK120	94AU925 (P100) Red HPU (P500) NBR (N100)	-30 to +110°C (-22°F to +230°F) -20 to +110°C (-7°F to +230°F) -30 to +110°C (-22°F to +230°F)	0.5 m/s
	DK123	94AU925 (P100) Red HPU (P500)	-30 to +110°C (-22°F to +230°F) -20 to +110°C (-7°F to +230°F)	0.5 m/s
	DK126	94AU925 (P100) Red HPU (P500) NBR (N100)	-30 to +110°C (-22°F to +230°F) -20 to +110°C (-7°F to +230°F) -30 to +110°C (-22°F to +230°F)	0.5 m/s
	DK 143	94AU925 (P100)/NBR Red HPU (P500)/NBR	-30 to +110°C (-22°F to +230°F) -20 to +110°C (-7°F to +230°F)	0.5 m/s

› PTFE ZAPTIVAČI KLIPA

› Standardne dimenzije ‹

ØD	Ød	L	C/S
8-14.9	ØD+4.9	2.2	2.45
15-39.9	ØD+0.5	3.2	3.75
40-79.9	ØD+11.0	4.2	5.5
80-132.9	ØD+5.5	6.3	7.75
133-329.9	ØD+21.0	8.1	10.5
330-649.9	ØD+24.5	8.1	12.25
≥650	ØD+28.0	9.5	14.0

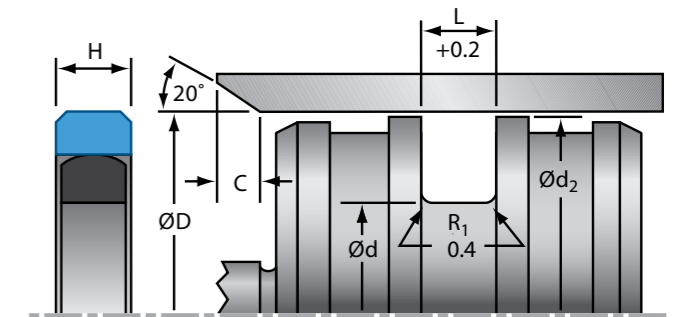

MIN. I MAKS. VREDNOSTI	R _{Max}	R _a	R _{pkx}	R _{pk}	R _k	R _{vk}	R _{vkx}
KLIZNA POVRŠINA	≤2.5µm	0.05 - 0.3µm	<0.5µm	<0.5µm	0.25 - 0.7µm	0.2 - 0.65µm	0.2 - 2.0µm
DNO KANALA	≤6.3µm						
BOČNE STRANE KANALA	≤15µm						

› Profili PTFE zaptivača klipa ‹

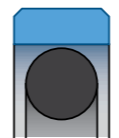
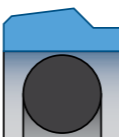
PROFIL	TIP	STANDARDNI MATERIJALI	TEMPERATURNO PODRUČJE	AKSIJALNA BRZINA
	DK108	PTFE Bronze / NBR PTFE Glass / NBR PTFE Bronze / FPM PTFE Glass / FPM	-30 to +120°C (-22°F to +248°F) -30 to +120°C (-22°F to +248°F) -10 to +200°C (-14°F to +390°F) -10 to +200°C (-14°F to +390°F)	5.0 m/s
	DK125	PTFE Bronze / NBR PTFE Glass / NBR PTFE Bronze / FPM PTFE Glass / FPM	-30 to +120°C (-22°F to +248°F) -30 to +120°C (-22°F to +248°F) -10 to +200°C (-14°F to +390°F) -10 to +200°C (-14°F to +390°F)	5.0 m/s

> PTFE ZAPTIVAČI KLIPA

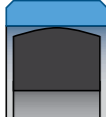
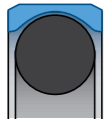
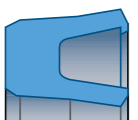
PROFIL	TIP	STANDARDNI MATERIJALI	TEMPERATURNI PODRUČJE	AKSIJALNA BRZINA
	DK138	PTFE Bronze / NBR PTFE Glass / NBR PTFE Bronze / FPM PTFE Glass / FPM	-30 to +120°C (-22°F to +248°F) -30 to +120°C (-22°F to +248°F) -10 to +200°C (-14°F to +390°F) -10 to +200°C (-14°F to +390°F)	5.0 m/s
	DK238	PTFE Bronze / NBR PTFE Glass / NBR PTFE Bronze / FPM PTFE Glass / FPM	-30 to +120°C (-22°F to +248°F) -30 to +120°C (-22°F to +248°F) -10 to +200°C (-14°F to +390°F) -10 to +200°C (-14°F to +390°F)	5.0 m/s
	DK142	PTFE Bronze / NBR PTFE Glass / NBR PTFE Bronze / FPM PTFE Glass / FPM	-30 to +120°C (-22°F to +248°F) -30 to +120°C (-22°F to +248°F) -10 to +200°C (-14°F to +390°F) -10 to +200°C (-14°F to +390°F)	5.0 m/s
	DK222	PTFE Bronze / NBR / POM PTFE Glass / NBR / POM PTFE Bronze / FPM / POM PTFE Glass / FPM / POM	-30 to +120°C (-22°F to +248°F) -30 to +120°C (-22°F to +248°F) -10 to +200°C (-14°F to +390°F) -10 to +200°C (-14°F to +390°F)	5.0 m/s
	DK139	PTFE Bronze/SS PTFE Glass/SS	-200 to +260°C (-328°F to +500°F) -200 to +260°C (-328°F to +500°F)	5.0 m/s
	DK119	PTFE Bronze/SS PTFE Glass/SS	-200 to +260°C (-328°F to +500°F) -200 to +260°C (-328°F to +500°F)	5.0 m/s

> ROTACIONI OSOVINSKI ZAPTIVAČI

> Standardne dimenzije <

ØD	S _{Profile}	L
>100	20	16
>250	22	20
>450	25	22
>750	25	25

> Profili rotacionih osovinskih zaptivača <



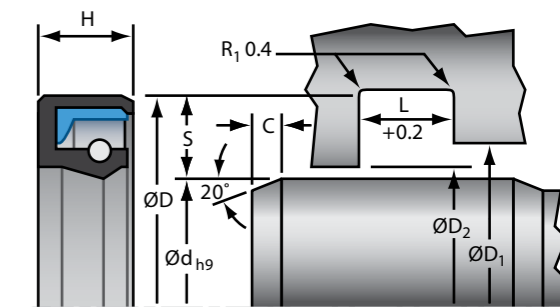



PROFIL	TIP	STANDARDNI MATERIJALI	TEMPERATURNI PODRUČJE	AKSIJALNA BRZINA
	DR101	NBR (N100)/NYL/SS	-30 to +100°C (-22°F to +212°F)	10.0 m/s
	DR102	NBR (N100)/NYL/SS	-30 to +100°C (-22°F to +212°F)	10.0 m/s
	DR201	NBR (N100)/NYL/SS	-30 to +100°C (-22°F to +212°F)	10.0 m/s
	DR202	NBR (N100)/NYL/SS	-30 to +100°C (-22°F to +212°F)	10.0 m/s
	DR203	NBR (N100) / NYL	-30 to +100°C (-22°F to +212°F)	10.0 m/s

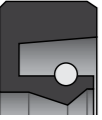

MIN. I MAKS. VREDNOSTI

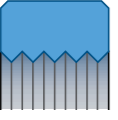
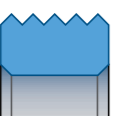
	R _{Max}	R _a
KLIZNA POVRŠINA	≤2.5µm	0.6µm
DNO KANALA	≤15µm	≤4.0µm

› Rotacioni osovinski zaptivači ‹

PROFIL	TIP	STANDARDNI MATERIJALI	TEMPERATURNO PODRUČJE	AKSIJALNA BRZINA
	DR204	NBR (N100)/SS	-30 to +100°C (-22°F to +212°F)	10.0 m/s
	DR205	NBR (N100)/SS	-30 to +100°C (-22°F to +212°F)	10.0 m/s
	DR206	NBR (N100)	-30 to +100°C (-22°F to +212°F)	10.0 m/s
	DR104	94AU925 (P100) Red HPU (P500) NBR (N100)	-30 to +110°C (-22°F to +230°F) -20 to +110°C (-7°F to +230°F) -30 to +110°C (-22°F to +230°F)	0.2 m/s
	DR105	94AU925 (P100) Red HPU (P500) NBR (N100)	-30 to +110°C (-22°F to +230°F) -20 to +110°C (-7°F to +230°F) -30 to +110°C (-22°F to +230°F)	0.2 m/s
	DR106	NBR (N100)	-30 to +110°C (-22°F to +230°F)	12.0 m/s
	DR108	94AU925 (P100) Red HPU (P500) NBR (N100)	-30 to +110°C (-22°F to +230°F) -20 to +110°C (-7°F to +230°F) -30 to +110°C (-22°F to +230°F)	0.5 m/s 0.5 m/s 10.0 m/s
	DR109	94AU925 (P100) Red HPU (P500) NBR (N100)	-30 to +110°C (-22°F to +230°F) -20 to +110°C (-7°F to +230°F) -30 to +110°C (-22°F to +230°F)	0.5 m/s 0.5 m/s 5.0 m/s

› PTFE ROTACIONI ZAPTIVAČI ‹

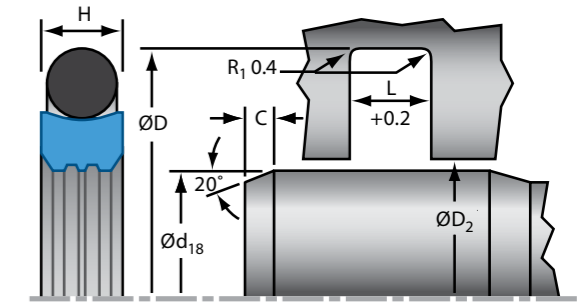

› Standardne dimenzije ‹

Ød	ØD	L	C/S
20-40	Ød+7.5	3.2	3.75
41-90	Ød+11.0	4.2	5.5
91-299	Ød+15.5	6.3	7.75
300-399	Ød+21.0	8.1	10.5
400-549	Ød+24.5	8.1	12.25
≥550	Ød+28.0	9.5	14.0

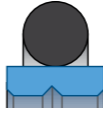
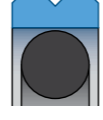
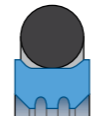
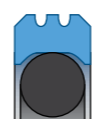

MIN. I MAKS. VREDNOSTI	R _{Max}	R _a
KLIZNA POVRŠINA	≤2.5µm	0.05-0.3µm
DNO KANALA	≤6.3µm	≤1.6µm
BOČNE STRANE KANALA	≤15µm	≤3µm

› Profili PTFE rotacionih zaptivača ‹

PROFIL	TIP	STANDARDNI MATERIJALI	TEMPERATURNO PODRUČJE	AKSIJALNA BRZINA
	DR110	PTFE Bronze / NBR PTFE Glass / NBR PTFE Graphite / NBR	-30 to +120°C (-22°F to +248°F) -30 to +120°C (-22°F to +248°F) -30 to +120°C (-22°F to +248°F)	0.5 m/s
	DR111	PTFE Bronze / NBR PTFE Glass / NBR PTFE Graphite / NBR	-30 to +120°C (-22°F to +248°F) -30 to +120°C (-22°F to +248°F) -30 to +120°C (-22°F to +248°F)	0.5 m/s
	DR115	PTFE Bronze / NBR PTFE Glass / NBR PTFE Graphite / NBR	-30 to +120°C (-22°F to +248°F) -30 to +120°C (-22°F to +248°F) -30 to +120°C (-22°F to +248°F)	0.5 m/s
	DR116	PTFE Bronze / NBR PTFE Glass / NBR PTFE Graphite / NBR	-30 to +120°C (-22°F to +248°F) -30 to +120°C (-22°F to +248°F) -30 to +120°C (-22°F to +248°F)	0.5 m/s
	DR117	PTFE Bronze / NBR PTFE Glass / NBR PTFE Graphite / NBR	-30 to +120°C (-22°F to +248°F) -30 to +120°C (-22°F to +248°F) -30 to +120°C (-22°F to +248°F)	0.5 m/s

BELEŠKE NOTES

MF Seals

POUZDAN PARTNER U TEHNICI ZAPTIVANJA

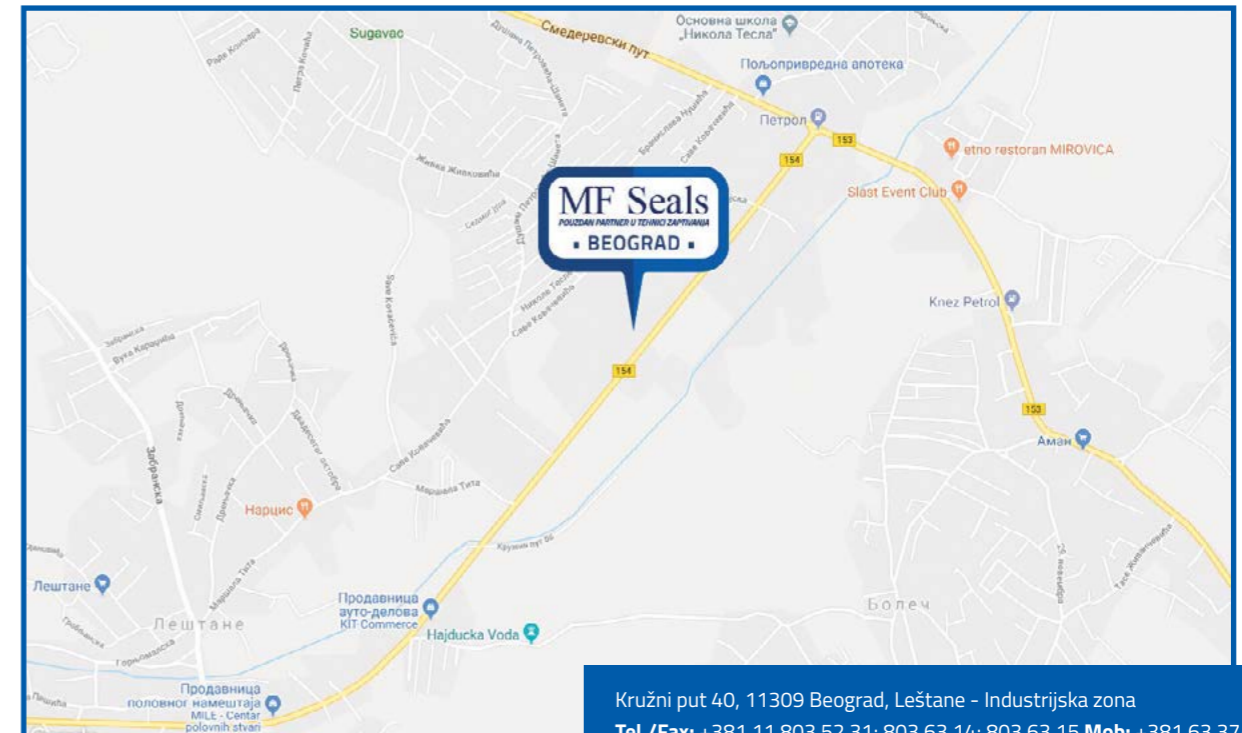

Kružni put 40, 11309 Beograd, Leštane - Industrijska zona

Tel./Fax: +381 11 803 52 31; 803 63 14; 803 63 15 Mob: +381 63 374 544

e-mail: mfseals@eunet.rs

www.mfseals.rs

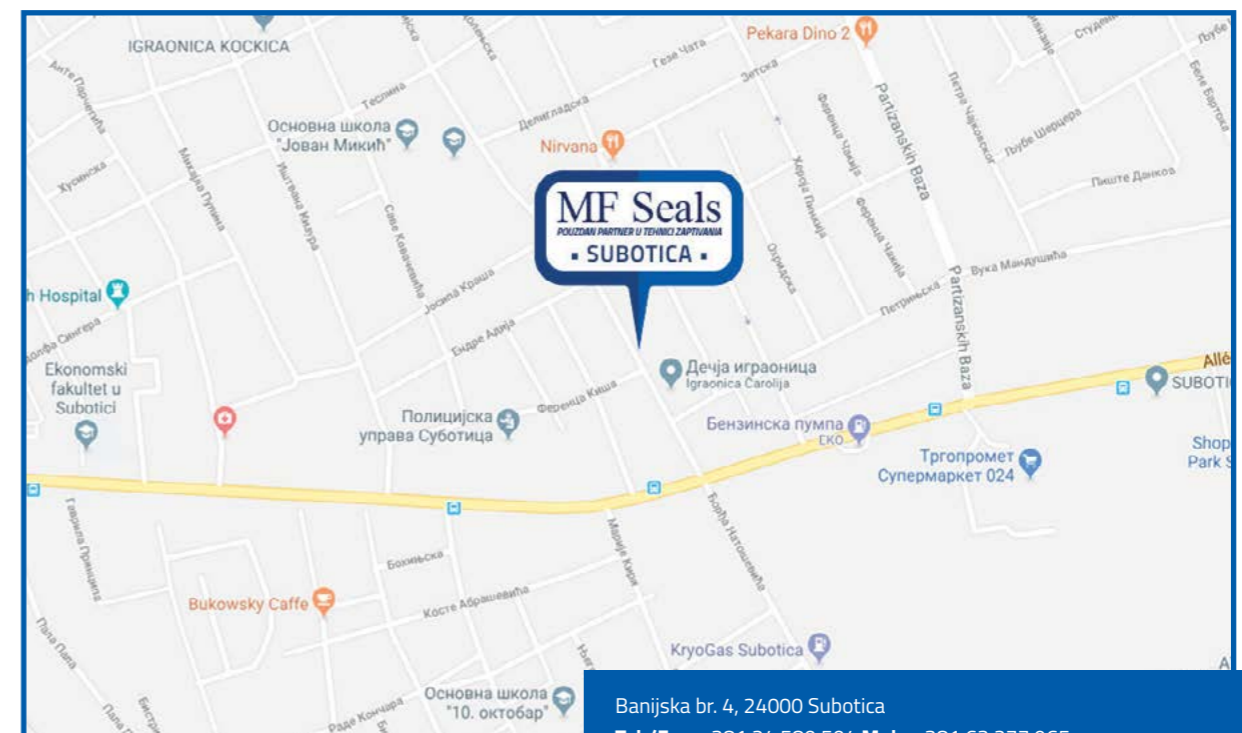

Banijska br. 4, 24000 Subotica

Tel./Fax: +381 24 580 504 Mob: +381 63 277 965

e-mail: mfseals.subotica@eunet.rs

www.mfseals.rs

MF Seals

POUZDAN PARTNER U TEHNICI ZAPTIVANJA

MF Seals BEOGRAD

*Kružni put br. 40
11 309 Leštane - Industrijska zona, Srbija*

*+381 11 80-35-231; 80-36-314
mfseals@eunet.rs*

MF Seals SUBOTICA

*Banijska br. 4
24000 Subotica, Srbija*

*+381 24 580-504; 63 277-965
mfseals.subotica@eunet.rs*

MF Seals SKOPLJE

*Dimo Hadži Dimov br. 40
1000 Skoplje, Makedonija*

*+389 2 27-00-340; 2 27-19-092
mfseals@t-home.mk*

www.mfseals.rs